



LIDL STORE	
Store Sales Area:	1063 m2
Warehouse Area:	260.7 m2
Welfare Area:	60.4 m2
Additional Storage:	96.4 m2
Store G.I.A.:	1503.2 m2

RESIDENTIAL	
Stair Core 1:	44.5 m ²
Bin Store:	17.8 m ²
Cycle Store 1:	17.8 m ²
Stair Core 2:	42.0 m ²
Plant Room:	17.2 m ²
Cycle Store 2:	17.0 m ²

RESIDENTIAL PARKING	
Standard Parking:	19 Spaces
Disabled Spaces:	2 Spaces
Total Parking:	21 spaces

- LIDL Demise
- Residential

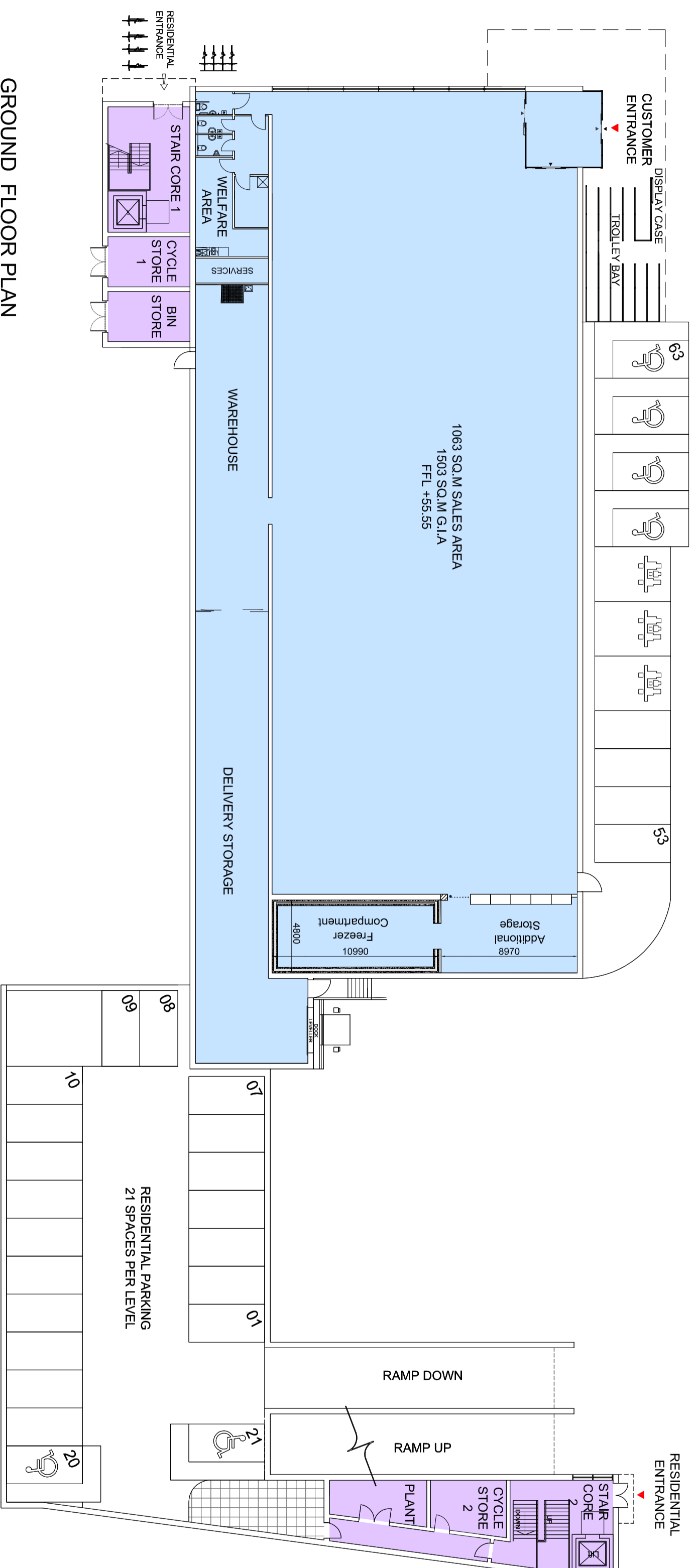

GROUND FLOOR PLAN

REV	DATE	DESCRIPTION	BY
		IN CASE OF DOUBT OR DISCREPANCIES PLEASE REFER TO ARCHITECT FOR INSTRUCTIONS. THIS DRAWING SHOULD NOT BE SCALED. THIS DRAWING IS COPYRIGHT.	

- 01 DESIGN
- 02 DESIGN CONCLUSION
- 03 PLANNING
- 04 PRODUCTION INFORMATION
- 05 BUILDING REGULATIONS
- 06 TENDERS
- 07 CONSTRUCTION
- 08 FINAL CONSTRUCTION
- 09 SHAVE

03. PLANNING

01. PRELIMINARY 02. FOR COMMENT 03. FOR APPROVAL

OTHER :

03. FOR APPROVAL

PROJECT :

PROPOSED LIDL STORE AT BRIGHTON ROAD SOUTH CROYDON CR2 6ES

DRAWING TITLE :

PROPOSED GROUND FLOOR PLAN

4th Floor, Greyfriars House
Greyfriars Road,
Cardiff, CF10 3AL

Tel: 029 2055 8900 Fax: 029 2039 9592
www.boyesirreeds.co.uk

Registered office, Ardmore Way, 295, East (England & Wales)

DATE :	15.05.2014	SCALE :	1:250 @A2
JOB NO. :	5074	DRAWN BY :	WW
DWG NO. :	5074 PL 11	REV. :	-

NICK GRIFFITHS
CAD REFERENCE: CroydonArchitecturalz_Plan012014
Drawing/Proposed Plans/PL 11/5074